

ELOTYPE 4E

Applications

To learn Braille:

Thanks to the easy handling of the ELOTYPE as a Braille-Writer and its constant and excellent braille dots the ELOTYPE can be perfectly used to learn braille. The easy to use and ergonomically arranged keyboard allows you to write over a long time without fatigue.

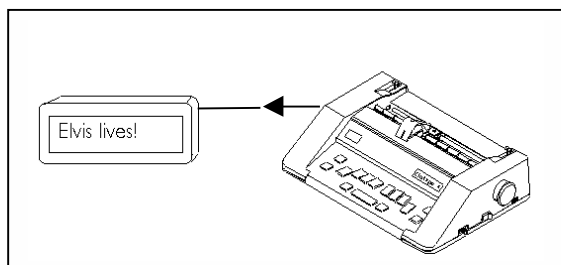

Read Braille in inkprint:

All characters entered on the ELOTYPE, are simultaneously embossed on the ELOTYPE and displayed visually in inkprint on a 40 characters, 4 lines electronic visualizer – called ELVIS-d+e.

ELVIS has a character memory of about two braille pages, which can be displayed by two buttons, where each press of the button shows next respectively previous 4 lines.

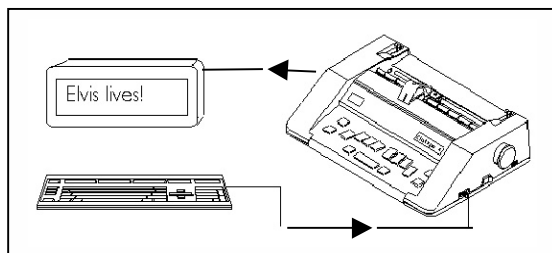

A communication system:

The ELOTYPE combined with a standard PC-keyboard and ELVIS enables the written communication between a blind and a sighted person who is without braille knowledge. All inputs whether entered via the Braille or the connected PC-keyboard, are embossed in Braille by the ELOTYPE and displayed visually on the ELVIS-d+e.

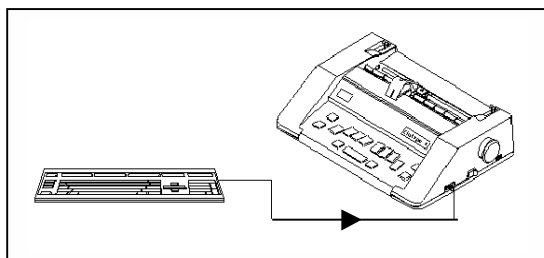

To learn the "touch-typing method":

With the ELOTYPE and a connected standard PC-keyboard, blind person are enabled to learn to write with 10 fingers on a standard keyboard. Since keyboard input and Braille output on the ELOTYPE are simultaneously executed, the blind got the tactile control at any time.

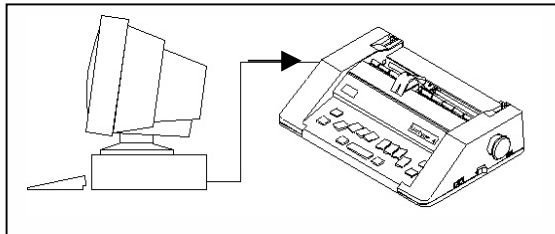

Braille and Graphics printer on a PC:

Via the serial port, the ELOTYPewriter prints text coming from a connected PC or a Braille notebook. The text is embossed in 6 or 8-dot Braille.

Graphics can be made and converted into a dot pattern by the new software "BrailleGraf vers. 1.0". After conversion data are sent via serial cable to the ELOTYPewriter and tactile graphics are printed with high resolution.

The ELOTYPewriter – "Connection"

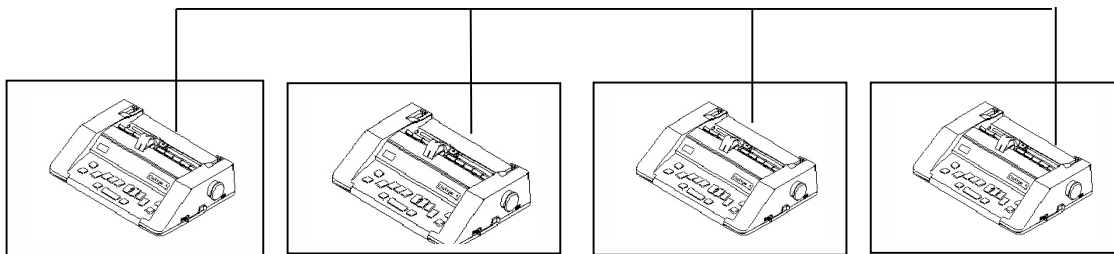

A special interface allows to group several ELOTYPewriter in a bi-directional combined network. Text written by a blind person on one machine is broadcast to all others in the compound and printed.

This communication system is especially suitable for deaf blind persons or as a "black board" substitute in classes.

ONE HAND OPERATION:

For blind persons with an additional disability of the hand we offer the ELOTYPewriter with an integrated one-hand-modul. With this special feature the blind is enabled to handle the machine with one hand up to one finger.

BRILLETEC also designs other individual keyboards, adjusted to special requirements. (Information on request)

Technical Data:

Size: 420 x 290 x 100 mm

Weight: 4,9 kg

Printing form: 2,5 mm dot spacing.
6 mm charact. spac.

Embossing speed: 8-dots full character
12 CPS

Text editor: battery-backup

max. paper width: 300 mm

max. paper length: unlimited

Paper: max. 160 g/m²

network interface: RS 485

Parallel interface: used for ordinary printer

Serial interface: used for PC, ELVIS-d+e